

PSE Porous Plastic Muffler

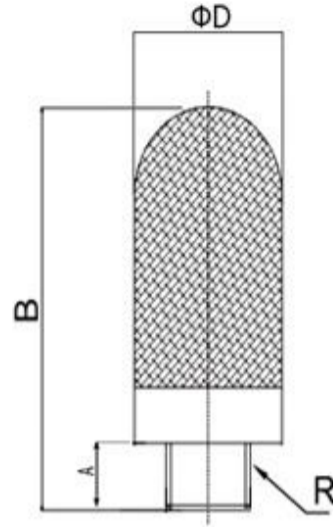

Body(noise absorbing material): Polyethylene
Base(thread): Polyethylene

Working Pressure: 0—1.0MPa | 0—150psi

Proof Pressure: 3.0Mpa | 435psi

Negative Pressure: -100Kpa | -29.5 In Hg

Working Temperature: -10°C~60°C | 14°F~140°F

| PART NO. | Sound Pressure Level* | R | A(mm) | B(mm) | D(mm) |
|----------|-----------------------|----------|-------|-------|-------|
| PSE M5 | - | M5 x 0.8 | 6 | 32 | 7 |
| PSE 01 | 78 | R1/8 | 7 | 33 | 13 |
| PSE 02 | 80 | R1/4 | 8 | 41 | 17 |
| PSE 03 | 85 | R3/8 | 10 | 65 | 25 |
| PSE 04 | 88 | R1/2 | 13.5 | 74 | 25 |
| PSE 06 | 90 | R3/4 | 15 | 137 | 37 |
| PSE 08 | 95 | R1 | 18 | 155 | 48 |
| PSE G01 | 78 | G1/8 | 7 | 33 | 13 |
| PSE G02 | 80 | G1/4 | 8 | 41 | 17 |
| PSE G03 | 85 | G3/8 | 10 | 65 | 25 |
| PSE G04 | 88 | G1/2 | 13.5 | 74 | 25 |
| PSE G06 | 90 | G3/4 | 15 | 137 | 37 |
| PSE G08 | 95 | G1 | 18 | 155 | 48 |
| PSE N01 | 78 | 1/8NPT | 7 | 33 | 13 |
| PSE N02 | 80 | 1/4NPT | 8 | 41 | 17 |
| PSE N03 | 85 | 3/8NPT | 10 | 65 | 25 |
| PSE N04 | 88 | 1/2NPT | 13.5 | 74 | 25 |
| PSE N06 | 90 | 3/4NPT | 15 | 137 | 37 |
| PSE N08 | 95 | 1NPT | 18 | 155 | 48 |

* Sound pressure level measured at 6 bar at 1 m distance.

** Information contained herein may be changed without prior notification.